

Fuse-base with Blade Contacts

刀型触头熔断器支持件 / 底座



Model of product 产品型号	Applicable fuse link size 配装熔断体尺码	Rated voltage 额定电压 (V)	Rated current 额定电流 (A)	Safety Approvals 安全认证
NH00B	NH000/NH00	690	160	CCC

Dimensions/ 尺寸:

Unit 单位: mm

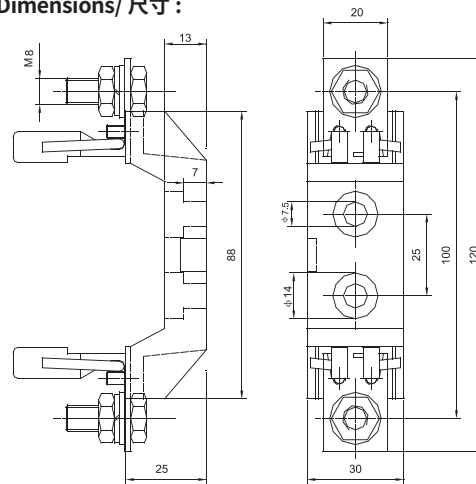

Model of product 产品型号	Catalog No. 目录编号	Applicable fuse link size 配装熔断体尺码	Rated voltage 额定电压 (V)	Rated current 额定电流 (A)	Safety Approvals 安全认证
NH1B	NH1B250U6 NH1B250U11	NH1	690	250	TUV CGC
			1100	250	
NH2B	NH2B400U6	NH2	690	400	
NH3B	NH3B630U6	NH3	690	630	

Dimensions/ 尺寸:

Unit 单位: mm

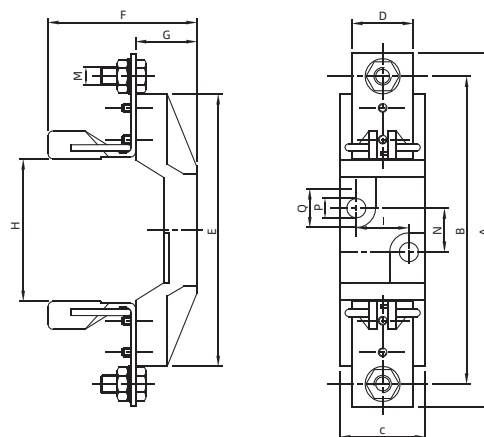

Size	A	B	C	D	E	F	G	H	I	M	N	P	Q
NH1	202	175	60	35	155	85	35	80	30	M10	25	10.5	20.5
NH2	224	200	60	35	155	90	35	80	30	M10	25	10.5	20.5
NH3	236	210	60	35	155	100	35	80	30	M10	25	10.5	20.5

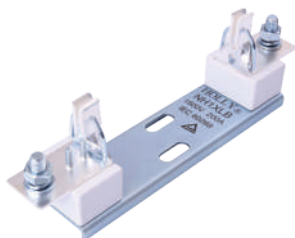

Model of product 产品型号	Catalog No. 目录编号	Applicable fuse link size 配装熔断体尺码	Rated voltage 额定电压 (V)	Rated current 额定电流 (A)	Safety Approvals 安全认证
NH1XLB	NH1XLB200U15	NH1XL	1500	200	TUV
NH2XLB	NH2XLB400U15	NH2XL	1500	400	
NH3LB	NH3LB400U11	NH2XL/NH3L	1100	400	TUV
NH3LB	NH3LB630U15	NH2XL/NH3L	1500	630	TUV

Dimensions/ 尺寸:

Unit 单位: mm

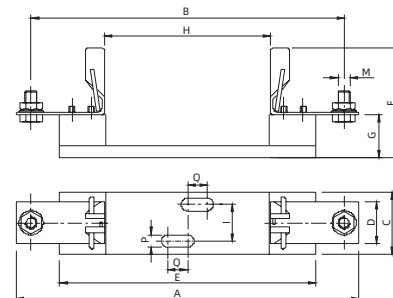

Size	A	B	C	D	E	F	G	H	I	M	P	Q
NH1XL	257	232	51	35	210	85	37	136	30	M10	10.5	16
NH2XL	281	257	51	35	210	90	37	136	30	M10	10.5	16
NH3L	292	267	51	35	210	100	37	136	30	M12	10.5	16